

KASNAK Pulley	A	B	C	T	P	R1	R2
XL	50°	2.3	1.27	2.57	5.08	0.38	0.38
L	40°	3.6	1.91	4.65	9.53	0.51	0.51
H	40°	4	2.29	6.12	12.7	1.02	1.02
XH	40°	11.2	6.35	12.57	22.23	1.19	1.57
XXH	40°	15.7	9.53	19.05	31.75	1.52	2.29

TİP Type	ADIM / Pitch	
	inc	mm
XL	50°	2.3
L	40°	3.6
H	40°	4
XH	40°	11.2
XXH	40°	15.7

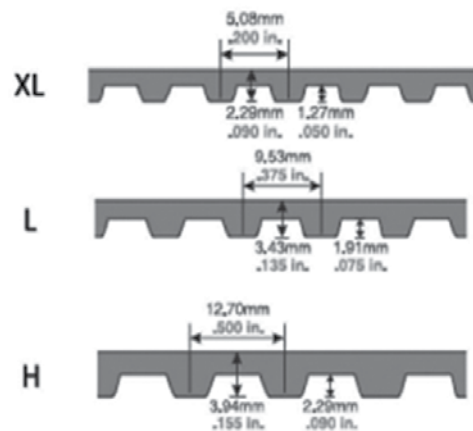

TYPE 1F

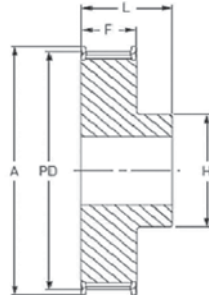

TYPE 1

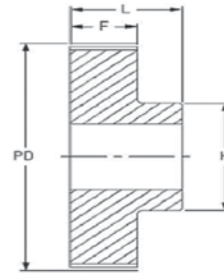

**XL 1/5" (5,08mm)**  
**PİLOT DELİKLİ / Pilot Bore**

XL037	ÇAP Diameter		TİP Type	Kayış Geniřlięi 6,4-7,9-9,5 mm For Belt Widths 6,4-7,9-9,5 mm				
	P.D	A		DELİK Bore		BOYUTLAR Dimension		
Dİř SAYISI Teeth No	mm	mm		Min. mm	Max. mm	H mm	F mm	L mm
10	16.17	23	1F	5	5	9.5	14.3	19.8
11	17.79	23	1F	5	5	9.5	14.3	19.8
12	19.4	25	1F	5	8	12.7	14.3	19.8
13	21.02	25	1F	6	8	12.7	14.3	19.8
14	22.64	28	1F	6	9	14.3	14.3	19.8
15	24.26	28	1F	6	11	15.9	14.3	19.8
16	25.87	32	1F	6	2	17.5	14.3	19.8
17	27.49	36	1F	6	13	20	14.3	19.8
18	29.11	36	1F	6	13	20.6	14.3	19.8
19	30.72	36	1F	6	13	23.8	14.3	19.8
20	32.34	38	1F	6	15	23.8	14.3	22.2
21	33.96	38	1F	6	15	25.4	14.3	22.2
22	35.57	42	1F	6	16	27	14.3	22.2
24	38.81	44	1F	6	18	30	14.3	22.2
26	42.04	48	1F	6	20	30	14.3	22.2
27	43.66	48	1F	6	20	30.2	14.3	22.2
28	45.28	51	1F	6	20	30.2	14.3	22.2
29	46.89	51	1F	6	20	34.9	14.3	22.2
30	48.51	54	1F	6	24	40	14.3	22.2
32	51.74	-	1	8	25	38	14.3	25.4
34	54.98	-	1	8	25	38	14.3	25.4
35	56.6	-	1	8	25	45	14.3	25.4
36	58.21	-	1	8	30	45	14.3	25.4
38	61.45	-	1	8	30	45	14.3	25.4
40	64.68	-	1	8	30	45	14.3	25.4
42	67.91	-	1	8	30	45	14.3	25.4
44	71.15	-	1	8	30	45	14.3	25.4
45	72.77	-	1	8	30	45	14.3	25.4
48	77.62	-	1	8	30	45	14.3	25.4
60	97.02	-	1	8	30	45	14.3	25.4
72	116.43	-	1	8	30	45	14.3	25.4

**L 3/8" (9.525mm)**  
**PILOT DELİKLİ / Pilot Bore**

L050			Kayış Geniřlięi 12,7 mm For Belt Widths 12,7 mm					
Diř SAYISI Teeth No	ÇAP Diameter		TİP Type	DELİK Bore		BOYUTLAR Dimension		
	P.D	A		Min.	Max.	H	F	L
	mm	mm		mm	mm	mm	mm	mm
10	30.32	36	1F	6	14	22	19	26
11	33.35	39	1F	6	14	22	19	26
12	36.38	42	1F	6	20	28	19	26
13	39.41	44	1F	6	20	30	19	26
14	42.45	48	1F	8	20	33	19	26
15	45.48	51	1F	8	23	36	19	26
16	48.51	54	1F	8	24	38	19	26
17	51.54	57	1F	10	24	40	19	26
18	54.57	60	1F	10	27	40	19	26
19	57.61	63	1F	10	27	40	19	26
20	60.64	66	1F	10	30	46	19	26
21	63.67	71	1F	10	30	46	19	26
22	66.7	75	1F	10	33	50	19	26
23	69.73	78	1F	10	33	50	19	26
24	72.77	79	1F	12	33	50	19	26
25	75.8	85	1F	12	33	50	19	26
26	78.83	87	1F	12	33	50	19	26
27	81.86	91	1F	12	33	50	19	26
28	84.89	91	1F	12	33	50	19	26
29	87.93	91	1F	12	33	50	19	26
30	90.96	97	1F	12	33	50	19	26
31	93.99	103	1F	12	33	50	19	26
32	97.02	103	1F	12	33	50	19	26
33	100.05	106	1F	12	33	50	19	26
34	103.08	115	1F	12	33	50	19	26
35	106.12	115	1F	12	33	50	19	26
36	109.15	115	1F	12	33	50	19	26
38	115.21	127	1F	12	33	50	19	26
40	121.28	127	1F	12	33	50	19	26
42	127.34	139	1F	12	33	50	19	26
44	133.4	140	1F	12	33	50	19	26
45	136.44	152	1F	12	33	50	19	26
48	145.53	152	1F	12	33	50	19	26
50	151.6	-	5	12	33	50	19	26
52	157.66	-	5	12	33	50	19	26
56	169.79	-	5	12	33	50	19	26
57	172.82	-	5	12	33	50	19	26
60	181.91	-	5	15	45	75	19	28
72	218.3	-	5	15	45	75	19	28
76	230.43	-	5	15	45	75	19	28
84	254.68	-	5	15	45	75	19	28
95	283.03	-	5	15	45	75	19	28
96	291.06	-	5	15	45	75	19	28

TYPE 1F

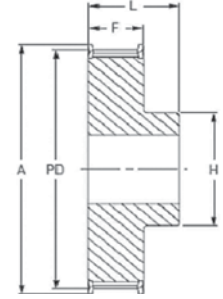

TYPE 5

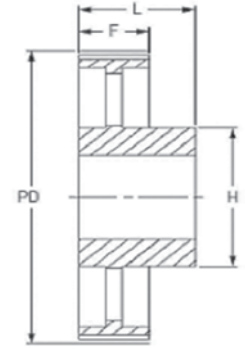

**L 3/8"(9.525mm)**  
**PİLOT DELİKLİ / Pilot Bore**

L075			Kayış Geniřlięi 19,1 mm For Belt Widths 19,1 mm					
	ÇAP Diameter		TİP Type	DELİK Bore		BOYUTLAR Dimension		
	P.D	A		Min.	Max.	H	F	L
Diř SAYISI Teeth No	mm	mm		mm	mm	mm	mm	mm
10	30.32	36	1F	6	14	22	25.4	38
11	33.35	39	1F	6	14	22	25.4	38
12	36.38	42	1F	6	20	28	25.4	38
13	39.41	45	1F	6	20	28	25.4	38
14	42.45	48	1F	8	20	28	25.4	38
15	45.48	51	1F	8	23	32	25.4	38
16	48.51	54	1F	8	24	36	25.4	38
17	51.54	57	1F	10	24	38	25.4	38
18	54.57	60	1F	10	27	40	25.4	38
19	57.61	63	1F	10	27	40	25.4	38
20	60.64	66	1F	10	30	46	25.4	38
21	63.67	69	1F	10	30	46	25.4	38
22	66.7	72	1F	10	33	50	25.4	38
23	69.73	78	1F	10	33	50	25.4	38
24	72.77	78	1F	12	33	50	25.4	38
25	75.8	85	1F	12	33	50	25.4	38
26	78.83	85	1F	12	33	50	25.4	38
27	81.86	91	1F	12	33	50	25.4	38
28	84.89	91	1F	12	33	50	25.4	38
29	87.93	91	1F	12	33	50	25.4	38
30	90.96	97	1F	12	33	50	25.4	38
31	93.99	103	1F	12	33	50	25.4	38
32	97.02	103	1F	12	33	50	25.4	38
33	100.05	106	1F	12	33	50	25.4	38
34	103.08	115	1F	12	33	50	25.4	38
35	106.12	115	1F	12	33	50	25.4	38
36	109.15	115	1F	12	33	50	25.4	38
38	115.21	127	1F	12	33	50	25.4	38
40	121.28	127	1F	12	33	50	25.4	38
42	127.34	139	1F	12	33	50	25.4	38
44	133.4	139	1F	12	33	50	25.4	38
45	136.44	152	1F	12	33	50	25.4	38
48	145.53	152	1F	12	33	50	25.4	38
50	151.6	-	5	12	33	50	25.4	38
52	157.66	-	5	12	33	50	25.4	38
56	169.79	-	5	12	33	50	25.4	38
57	172.82	-	5	12	33	50	25.4	38
60	191.91	-	5	15	45	75	25.4	45
72	218.3	-	5	15	45	75	25.4	45
76	230.43	-	5	15	45	75	25.4	45
84	254.68	-	5	15	45	75	25.4	45
95	283.03	-	5	15	45	75	25.4	45
96	291.06	-	5	15	45	75	25.4	45
120	363.83	-	5	15	70	120	25.4	45

TYPE 1F

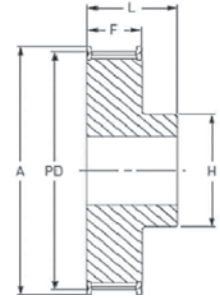

TYPE 5

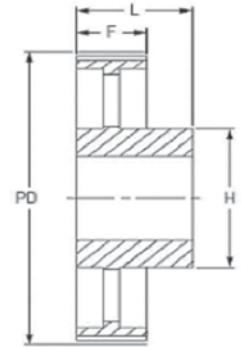

**L 3/8" (9.525mm)**  
**PILOT DELİKLİ / Pilot Bore**

L100			Kayış Geniřlięi 25,4 mm For Belt Widths 25,4 mm					
	ÇAP Diameter		TİP Type	DELİK Bore		BOYUTLAR Dimension		
	P.D	A		Min.	Max.	H	F	L
	mm	mm		mm	mm	mm	mm	mm
10	30.32	36	1F	6	14	22	32	45
11	33.35	39	1F	6	14	22	32	45
12	36.38	42	1F	6	20	28	32	45
13	39.41	45	1F	6	20	28	32	45
14	42.45	48	1F	8	20	28	32	45
15	45.48	51	1F	8	23	32	32	45
16	48.51	54	1F	8	24	36	32	45
17	51.54	57	1F	10	24	38	32	45
18	54.57	60	1F	10	27	40	32	45
19	57.61	63	1F	10	27	40	32	45
20	60.64	66	1F	10	30	46	32	45
21	63.67	69	1F	10	30	46	32	45
22	66.7	72	1F	10	33	50	32	45
23	69.73	78	1F	10	33	50	32	45
24	72.77	78	1F	12	33	50	32	45
25	75.8	85	1F	12	33	50	32	45
26	78.83	85	1F	12	33	50	32	45
27	81.86	91	1F	12	33	50	32	45
28	84.89	91	1F	12	33	50	32	45
29	87.93	91	1F	12	33	50	32	45
30	90.96	97	1F	12	33	50	32	45
31	93.99	103	1F	12	33	50	32	45
32	97.02	103	1F	12	33	50	32	45
33	100.05	106	1F	12	33	50	32	45
34	103.08	115	1F	12	33	50	32	45
35	106.12	115	1F	12	33	50	32	45
36	109.15	115	1F	12	33	50	32	45
38	115.21	127	1F	12	33	50	32	45
40	121.28	127	1F	12	33	50	32	45
42	127.34	139	1F	12	33	50	32	45
44	133.4	139	1F	12	33	50	32	45
45	136.44	152	1F	12	33	50	32	45
48	145.53	152	1F	12	33	50	32	45
50	151.6	-	5	12	33	50	32	45
52	157.66	-	5	12	33	50	32	45
56	169.79	-	5	12	33	50	32	45
57	172.82	-	5	12	33	50	32	45
60	191.91	-	5	15	45	75	32	45
72	218.3	-	5	15	45	75	32	45
76	230.43	-	5	15	45	75	32	45
84	254.68	-	5	15	45	75	32	45
95	283.03	-	5	15	45	75	32	45
96	291.06	-	5	15	45	75	32	45
120	363.83	-	5	15	70	120	32	45

TYPE 1F

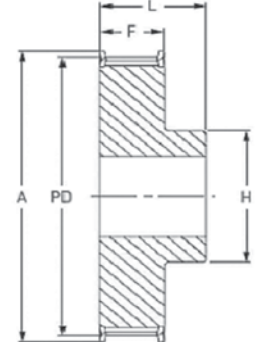

TYPE 5

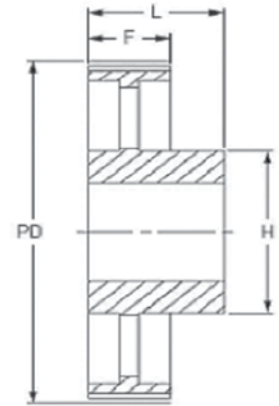

**H 1/2" (12,7mm)**  
**PİLOT DELİKLİ / Pilot Bore**

H075			Kayış Geniřliđi 19,1 mm For Belt Widths 19,1 mm					
Diř SAYISI Teeth No	ÇAP Diameter		TİP Type	DELİK Bore		BOYUTLAR Dimension		
	P.D	A		Min.	Max.	H	F	L
	mm	mm		mm	mm	mm	mm	mm
14	56.6	63	1F	10	27	40	27	40
15	60.64	67	1F	10	30	46	27	40
16	64.68	71	1F	10	30	45	27	40
17	68.72	75	1F	10	30	46	27	40
18	72.77	79	1F	12	36	55	27	40
19	76.81	83	1F	12	40	60	27	40
20	80.85	87	1F	12	41	62	27	40
21	84.89	91	1F	12	43	67	27	40
22	88.94	95	1F	12	45	70	27	40
23	92.98	98	1F	12	46	72	27	40
24	97.02	103	1F	12	47	75	27	40
25	101.06	107	1F	12	47	75	27	40
26	105.11	111	1F	15	54	80	27	40
27	109.15	115	1F	15	54	80	27	40
28	113.19	119	1F	15	54	80	27	40
29	117.23	123	1F	15	54	80	27	40
30	121.28	127	1F	15	54	80	27	40
31	125.32	131	1F	15	54	80	27	40
32	129.36	135	1F	15	54	80	27	40
33	133.4	142	1F	15	54	80	27	40
34	137.45	142	1F	15	54	80	27	40
35	141.49	151	1F	15	54	80	27	40
36	145.53	151	1F	20	54	80	27	40
38	153.62	158	1F	20	54	80	27	40
40	161.7	168	1F	20	54	80	27	40
42	169.79	184	1F	20	54	80	27	40
44	177.87	184	5F	20	54	80	27	40
45	181.91	192	5F	20	54	80	27	40
48	194.04	200	5F	20	54	80	27	40
50	202.13	-	5	20	54	80	27	40

TYPE 1F

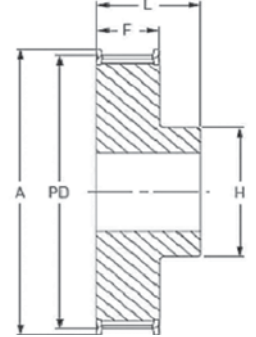

TYPE 5F

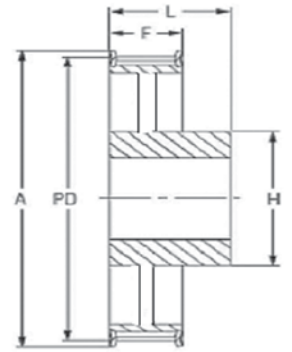

TYPE 5

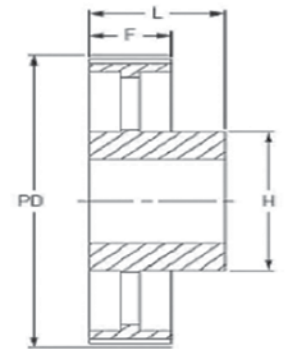

**H 1/2" (12,7mm)**  
**PILOT DELİKLİ / Pilot Bore**

H100	Kayış Geniřliđi 25,4 mm For Belt Widths 25,4 mm							
Diř SAYISI Teeth No	ÇAP Diameter		TİP Type	DELİK Bore		BOYUTLAR Dimension		
	P.D	A		Min.	Max.	H	F	L
	mm	mm		mm	mm	mm	mm	mm
14	56.6	63	1F	10	27	40	33.3	45
15	60.64	67	1F	10	30	46	33.3	45
16	64.68	71	1F	10	30	46	33.3	45
17	68.72	75	1F	10	30	46	33.3	45
18	72.77	79	1F	12	36	55	33.3	45
19	76.81	83	1F	12	40	60	33.3	45
20	80.85	87	1F	12	41	62	33.3	45
21	84.89	91	1F	12	43	67	33.3	45
22	88.94	95	1F	12	45	70	33.3	45
23	92.98	98	1F	12	46	72	33.3	45
24	97.02	103	1F	12	47	75	33.3	45
25	101.06	107	1F	12	47	75	33.3	45
26	105.11	111	1F	15	54	80	33.3	45
27	109.15	115	1F	15	54	80	33.3	45
28	113.19	119	1F	15	54	80	33.3	45
29	117.23	123	1F	15	54	80	33.3	45
30	121.28	127	1F	15	54	80	33.3	45
31	125.32	131	1F	15	54	80	33.3	45
32	129.36	135	1F	15	54	80	33.3	45
33	133.4	142	1F	15	54	80	33.3	45
34	137.45	142	1F	15	54	80	33.3	45
35	141.49	151	1F	15	54	80	33.3	45
36	145.53	151	1F	20	54	80	33.3	45
38	153.62	158	1F	20	54	80	33.3	45
40	161.7	168	1F	20	54	80	33.3	45
42	169.79	184	1F	20	54	80	33.3	45
44	177.87	184	5F	20	54	80	33.3	50
45	181.91	192	5F	20	54	80	33.3	50
48	194.04	200	5F	20	54	90	33.3	50
50	202.13	-	5	20	54	90	33.3	50
52	210.21	-	5	20	54	90	33.3	50
57	230.42	-	5	20	54	90	33.3	50
58	234.47	-	5	20	54	90	33.3	50
60	242.55	-	5	20	70	120	33.3	50
70	282.98	-	5	20	70	120	33.3	55
72	291.06	-	5	20	70	120	33.3	55
76	307.23	-	5	20	70	120	33.3	55
84	339.57	-	5	20	70	120	33.3	55
96	388.08	-	5	24	70	120	33.3	60
120	485.1	-	5	24	70	120	33.3	60
156	630.63	-	5	24	70	120	33.3	60

TYPE 1F

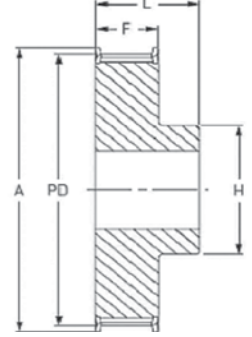

TYPE 5F

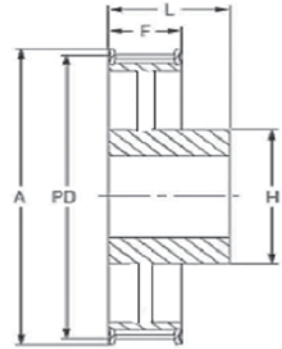

TYPE 5

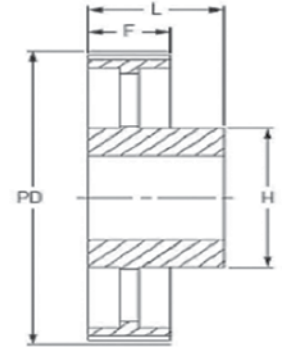

**H 1/2" (12,7mm)**  
**PİLOT DELİKLİ / Pilot Bore**

TYPE 1F

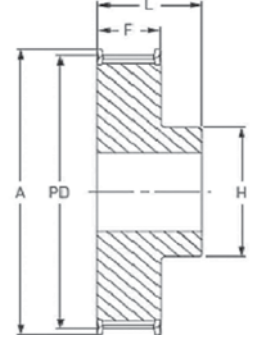

TYPE 5F

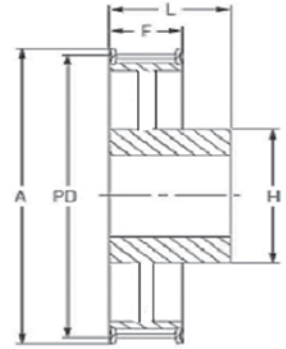

TYPE 5

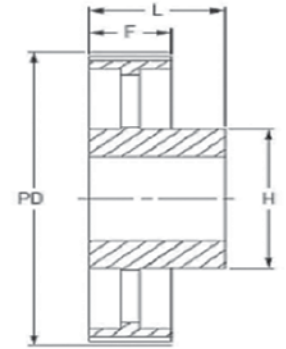

Diş SAYISI Teeth No	Kayış Geniřlięi 38,1 mm For Belt Widths 38,1 mm							
	ÇAP Diameter		TİP Type	DELİK Bore		BOYUTLAR Dimension		
	P.D	A		Min.	Max.	H	F	L
	mm	mm		mm	mm	mm	mm	mm
14	56.6	63	1F	10	27	40	46	58
15	60.64	67	1F	10	30	46	46	58
16	64.68	71	1F	10	30	46	46	58
17	68.72	75	1F	10	30	46	46	58
18	72.77	79	1F	12	36	55	46	58
19	76.81	83	1F	12	40	60	46	58
20	80.85	87	1F	12	41	62	46	58
21	84.89	91	1F	12	43	67	46	58
22	88.94	95	1F	12	45	70	46	58
23	92.98	98	1F	12	46	72	46	58
24	97.02	103	1F	12	47	75	46	58
25	101.06	107	1F	12	47	75	46	58
26	105.11	111	1F	15	54	80	46	58
27	109.15	115	1F	15	54	80	46	58
28	113.19	119	1F	15	54	80	46	58
29	117.23	123	1F	15	54	80	46	58
30	121.28	127	1F	15	54	80	46	58
31	125.32	131	1F	15	54	80	46	58
32	129.36	135	1F	15	54	80	46	58
33	133.4	142	1F	15	54	80	46	58
34	137.45	142	1F	15	54	80	46	58
35	141.49	151	1F	15	54	80	46	58
36	145.53	151	1F	20	54	80	46	58
38	153.62	158	1F	20	54	80	46	58
40	161.7	168	1F	20	54	80	46	58
42	169.79	184	1F	20	54	80	46	58
44	177.87	184	5F	20	54	80	46	58
45	181.91	192	5F	20	54	80	46	58
48	194.04	200	5F	20	54	90	46	65
50	202.13	-	5	20	54	90	46	65
52	210.21	-	5	20	54	90	46	65
57	230.42	-	5	20	54	90	46	65
58	234.47	-	5	20	54	90	46	65
60	242.55	-	5	20	70	120	46	65
70	282.98	-	5	20	70	120	46	65
72	291.06	-	5	20	70	120	46	65
76	307.23	-	5	20	70	120	46	65
84	339.57	-	5	20	70	120	46	65
96	388.08	-	5	24	70	120	46	65
120	485.1	-	5	24	70	120	46	65
156	630.63	-	5	24	70	120	46	65



**H 1/2" (12,7mm)**  
**PILOT DELİKLİ / Pilot Bore**

H200	Kayış Geniřliđi 50,8 mm For Belt Widths 50,8 mm							
Diř SAYISI Teeth No	ÇAP Diameter		TİP Type	DELİK Bore		BOYUTLAR Dimension		
	P.D	A		Min.	Max.	H	F	L
	mm	mm		mm	mm	mm	mm	mm
14	56.6	63	1F	10	27	40	59.5	70
15	60.64	67	1F	10	30	46	59.5	70
16	64.68	71	1F	10	30	46	59.5	70
17	68.72	75	1F	10	30	46	59.5	70
18	72.77	79	1F	12	36	55	59.5	70
19	76.81	83	1F	12	40	60	59.5	70
20	80.85	87	1F	12	41	62	59.5	70
21	84.89	91	1F	12	43	67	59.5	70
22	88.94	95	1F	12	45	70	59.5	70
23	92.98	98	1F	12	46	72	59.5	70
24	97.02	103	1F	12	47	75	59.5	70
25	101.06	107	1F	12	47	75	59.5	70
26	105.11	111	1F	15	54	80	59.5	70
27	109.15	115	1F	15	54	80	59.5	70
28	113.19	119	1F	15	54	80	59.5	70
29	117.23	123	1F	15	54	80	59.5	70
30	121.28	127	1F	15	54	80	59.5	70
31	125.32	131	1F	15	54	80	59.5	70
32	129.36	135	1F	15	54	80	59.5	70
33	133.4	142	1F	15	54	80	59.5	70
34	137.45	142	1F	15	54	80	59.5	70
35	141.49	151	1F	15	54	80	59.5	70
36	145.53	151	1F	20	54	80	59.5	70
38	153.62	158	1F	20	54	80	59.5	70
40	161.7	168	1F	20	54	80	59.5	70
42	169.79	184	1F	20	54	80	59.5	70
44	177.87	184	5F	20	54	80	59.5	70
45	181.91	192	5F	20	54	80	59.5	70
48	194.04	200	5F	20	54	90	59.5	75
50	202.13	-	5	20	54	90	59.5	75
52	210.21	-	5	20	54	90	59.5	75
57	230.42	-	5	20	54	90	59.5	75
58	234.47	-	5	20	54	90	59.5	75
60	242.55	-	5	20	70	120	59.5	75
70	282.98	-	5	20	70	120	59.5	75
72	291.06	-	5	20	70	120	59.5	75
76	307.23	-	5	20	70	120	59.5	75
84	339.57	-	5	20	70	120	59.5	75
96	388.08	-	5	24	70	120	59.5	75
120	485.1	-	5	24	70	120	59.5	75
156	630.63	-	5	24	70	130	59.5	75

TYPE 1F

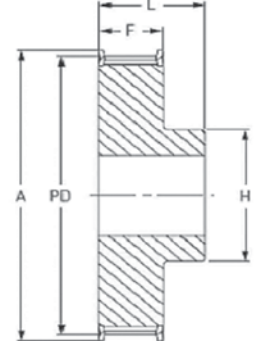

TYPE 5F

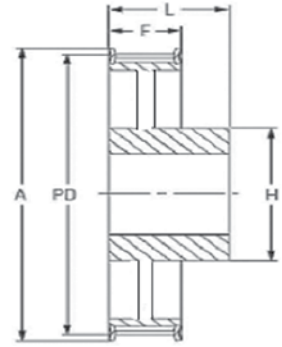

TYPE 5

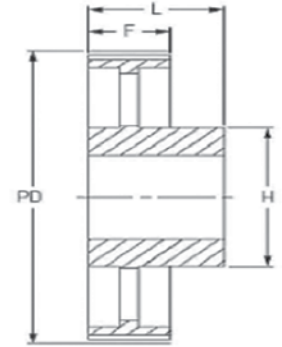

**H 1/2" (12,7mm)**  
**PILOT DELİKLİ / Pilot Bore**

TYPE 1F

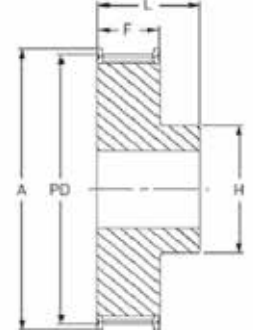

H300	Kayış Geniřlięi 76,2 mm For Belt Widths 76,2 mm								
	Diř SAYISI Teeth No	ÇAP Diameter		TİP Type	DELİK Bore		BOYUTLAR Dimension		
		P.D	A		Min.	Max.	H	F	L
		mm	mm		mm	mm	mm	mm	mm
14	56.6	63	1F	10	27	40	85.5	100	
15	60.64	67	1F	10	30	46	85.5	100	
16	64.68	71	1F	10	30	46	85.5	100	
17	68.72	75	1F	10	30	46	85.5	100	
18	72.77	79	1F	12	36	55	85.5	100	
19	76.81	83	1F	12	40	60	85.5	100	
20	80.85	87	1F	12	41	62	85.5	100	
21	84.89	91	1F	12	43	67	85.5	100	
22	88.94	95	1F	12	45	70	85.5	100	
23	92.98	98	1F	12	46	72	85.5	100	
24	97.02	103	1F	12	47	75	85.5	100	
25	101.06	107	1F	12	47	75	85.5	100	
26	105.11	111	1F	15	54	80	85.5	100	
27	109.15	115	1F	15	54	80	85.5	100	
28	113.19	119	1F	15	54	80	85.5	100	
29	117.23	123	1F	15	54	80	85.5	100	
30	121.28	127	1F	15	54	80	85.5	100	
31	125.32	131	1F	15	54	80	85.5	100	
32	129.36	135	1F	15	54	80	85.5	100	
33	133.4	142	1F	15	54	80	85.5	100	
34	137.45	142	1F	15	54	80	85.5	100	
35	141.49	151	1F	15	54	80	85.5	100	
36	145.53	151	1F	20	54	80	85.5	100	
38	153.62	158	1F	20	54	80	85.5	100	
40	161.7	168	1F	20	54	80	85.5	100	
42	169.79	184	1F	20	54	80	85.5	100	
44	177.87	184	5F	20	54	80	85.5	100	
45	181.91	192	5F	20	54	80	85.5	100	
48	194.04	200	5F	20	54	90	85.5	100	
50	202.13	-	5	20	54	90	85.5	100	
52	210.21	-	5	20	54	90	85.5	100	
57	230.42	-	5	20	54	90	85.5	100	
58	234.47	-	5	20	54	90	85.5	100	
60	242.55	-	5	20	70	120	85.5	100	
70	282.98	-	5	20	70	120	85.5	100	
72	291.06	-	5	20	70	120	85.5	100	
76	307.23	-	5	20	70	120	85.5	100	
84	339.57	-	5	20	70	120	85.5	100	
96	388.08	-	5	24	70	120	85.5	100	
120	485.1	-	5	24	70	120	85.5	100	
156	630.63	-	5	24	70	130	85.5	100	

TYPE 5F

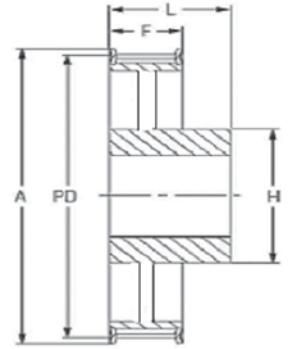

TYPE 5

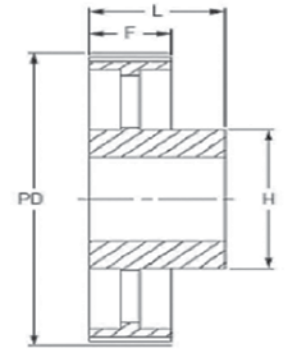

**XH 7/8"(22,225mm)**  
**PILOT DELİKLİ / Pilot Bore**

XH200	Kayış Geniřlięi 50,8 mm For Belt Widths 50,8 mm							
	ÇAP Diameter		TİP Type	DELİK Bore		BOYUTLAR Dimension		
	P.D	A		Min.	Max.	H	F	L
Diř SAYISI Teeth No	mm	mm		mm	mm	mm	mm	mm
18	127.34	141	1F	24	67	100	65.1	80
19	134.41	146	1F	24	67	100	65.1	80
20	141.49	155	1F	24	67	100	65.1	80
21	148.56	169	1F	24	73	110	65.1	80
22	155.64	176	1F	24	73	110	65.1	80
24	169.79	183	1F	24	8	120	65.1	80
25	176.86	198	1F	24	80	120	65.1	80
26	183.93	205	1F	24	80	120	65.1	80
27	191.01	212	1F	24	80	120	65.1	80
28	198.09	212	1F	24	80	120	65.1	80
30	212.23	226	1F	24	80	120	65.1	80
32	226.38	240	1F	24	80	120	65.1	80
34	240.53	256	1F	24	80	120	65.1	80
38	268.83	-	5	28	100	150	65.1	80
40	282.98	-	5	28	100	150	65.1	100
48	339.57	-	5	28	100	150	65.1	100
60	424.47	-	5	28	100	150	65.1	100

TYPE 1F

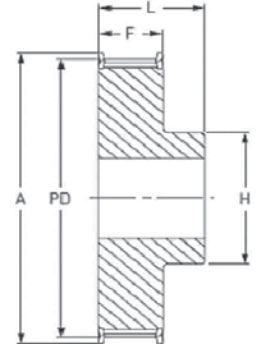

TYPE 5

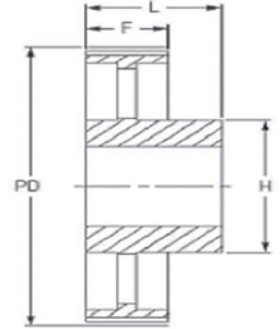

**XH 7/8"(22,225mm)**  
**PILOT DELİKLİ / Pilot Bore**

XH300	Kayış Geniřlięi 76,2 mm For Belt Widths 76,2 mm							
	ÇAP Diameter		TİP Type	DELİK Bore		BOYUTLAR Dimension		
	P.D	A		Min.	Max.	H	F	L
Diř SAYISI Teeth No	mm	mm		mm	mm	mm	mm	mm
18	127.34	141	1F	24	67	100	92.1	110
19	134.41	146	1F	24	67	100	92.1	110
20	141.49	155	1F	24	67	100	92.1	110
21	148.56	169	1F	24	73	110	92.1	110
22	155.64	176	1F	24	73	110	92.1	110
24	169.79	183	1F	24	8	120	92.1	110
25	176.86	198	1F	24	80	120	92.1	110
26	183.93	205	1F	24	80	120	92.1	110
27	191.01	212	1F	24	80	120	92.1	110
28	198.09	212	1F	24	80	120	92.1	110
30	212.23	226	1F	24	80	120	92.1	110
32	226.38	240	1F	24	80	120	92.1	110
34	240.53	256	1F	24	80	120	92.1	110
38	268.83	-	5	28	100	150	92.1	120
40	282.98	-	5	28	100	150	92.1	120
48	339.57	-	5	28	100	150	92.1	120
60	424.47	-	5	28	100	150	92.1	120

TYPE 1F

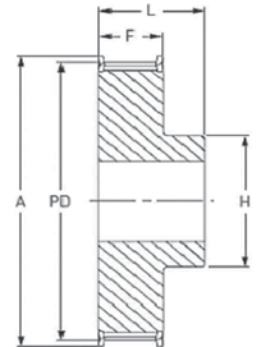

TYPE 5

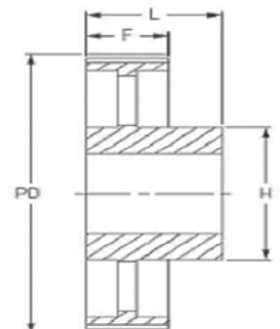

**H 1/2" (12,7mm)**  
**PILOT DELİKLİ / Pilot Bore**

Diş SAYISI Teeth No	Kayış Geniřliđi 76,2 mm For Belt Widths 76,2 mm							
	ÇAP Diameter		TİP Type	DELİK Bore		BOYUTLAR Dimension		
	P.D	A		Min.	Max.	H	F	L
	mm	mm		mm	mm	mm	mm	mm
14	56.6	63	1F	10	27	40	85.5	100
15	60.64	67	1F	10	30	46	85.5	100
16	64.68	71	1F	10	30	46	85.5	100
17	68.72	75	1F	10	30	46	85.5	100
18	72.77	79	1F	12	36	55	85.5	100
19	76.81	83	1F	12	40	60	85.5	100
20	80.85	87	1F	12	41	62	85.5	100
21	84.89	91	1F	12	43	67	85.5	100
22	88.94	95	1F	12	45	70	85.5	100
23	92.98	98	1F	12	46	72	85.5	100
24	97.02	103	1F	12	47	75	85.5	100
25	101.06	107	1F	12	47	75	85.5	100
26	105.11	111	1F	15	54	80	85.5	100
27	109.15	115	1F	15	54	80	85.5	100
28	113.19	119	1F	15	54	80	85.5	100
29	117.23	123	1F	15	54	80	85.5	100
30	121.28	127	1F	15	54	80	85.5	100
31	125.32	131	1F	15	54	80	85.5	100
32	129.36	135	1F	15	54	80	85.5	100
33	133.4	142	1F	15	54	80	85.5	100
34	137.45	142	1F	15	54	80	85.5	100
35	141.49	151	1F	15	54	80	85.5	100
36	145.53	151	1F	20	54	80	85.5	100
38	153.62	158	1F	20	54	80	85.5	100
40	161.7	168	1F	20	54	80	85.5	100
42	169.79	184	1F	20	54	80	85.5	100
44	177.87	184	5F	20	54	80	85.5	100
45	181.91	192	5F	20	54	80	85.5	100
48	194.04	200	5F	20	54	90	85.5	100
50	202.13	-	5	20	54	90	85.5	100
52	210.21	-	5	20	54	90	85.5	100
57	230.42	-	5	20	54	90	85.5	100
58	234.47	-	5	20	54	90	85.5	100
60	242.55	-	5	20	70	120	85.5	100
70	282.98	-	5	20	70	120	85.5	100
72	291.06	-	5	20	70	120	85.5	100
76	307.23	-	5	20	70	120	85.5	100
84	339.57	-	5	20	70	120	85.5	100
96	388.08	-	5	24	70	120	85.5	100
120	485.1	-	5	24	70	120	85.5	100
156	630.63	-	5	24	70	130	85.5	100

TYPE 1F

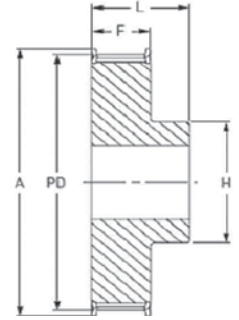

TYPE 5F

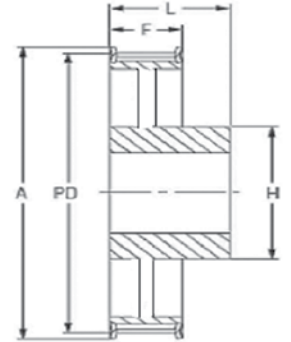

TYPE 5

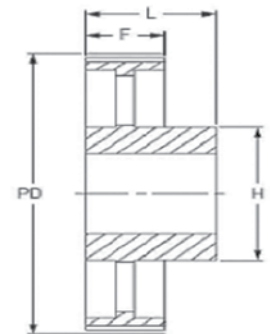

TYPE 3F

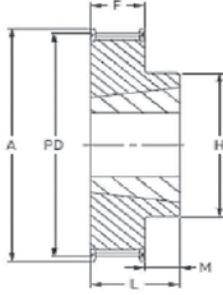

TYPE 9F

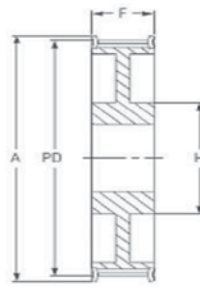

TYPE 9

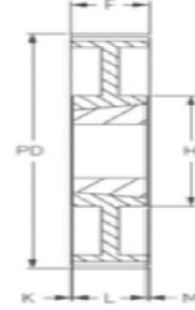

**L 3/8" (9,525mm)**

**KONİK BURÇLU / With Taper Bush**

L050	Kayış Geniřlięi 12,7 mm For Belt Widths 12,7 mm										
Diř SAYISI Teeth No	ÇAP Diameter		TİP Type	BURÇ Bush	DELİK Bore		BOYUTLAR Dimension				
	P.D	A			Min.	Max.	H	F	K	L	M
	mm	mm			mm	mm	mm	mm	mm	mm	mm
18	54.57	60	3F	1108	10	28	45	19.1	-	22	3
19	57.61	63	3F	1108	10	28	45	19.1	-	22	3
20	60.64	66	3F	1108	10	28	47	19.1	-	22	3
21	63.67	69	3F	1108	10	28	49	19.1	-	22	3
22	66.7	72	3F	1108	10	28	53	19.1	-	22	3
23	69.73	78	3F	1108	10	28	54	19.1	-	22	3
24	72.77	78	3F	1108	10	28	54	19.1	-	22	3
25	75.8	85	3F	1108	10	28	56	19.1	-	22	3
26	78.83	85	3F	1108	10	28	60	19.1	-	22	3
27	81.86	91	3F	1108	10	28	62	19.1	-	22	3
28	84.89	91	3F	1108	10	28	63	19.1	-	22	3
30	90.96	97	3F	1108	10	28	70	19.1	-	22	3
32	97.02	103	3F	1108	10	28	74	19.1	-	22	3
36	109.15	115	3F	1108	10	28	85	19.1	-	22	3
40	121.28	127	3F	1610	13	42	90	19.1	-	25	6
42	127.34	139	3F	1610	13	42	90	19.1	-	25	6
44	133.4	139	3F	1610	13	42	92	19.1	-	25	6
48	145.53	152	9F	1610	13	42	92	19.1	-	25	3
60	191.91	-	9	1610	13	42	92	19.1	3	25	3
72	218.3	-	9	1610	13	42	92	19.1	3	25	3
84	254.68	-	9	1610	13	42	92	19.1	3	25	3
96	291.06	-	9	2012	19	50	111	19.1	6.5	32	6.5
120	363.83	-	9	2012	19	50	111	19.1	6.5	32	6.5

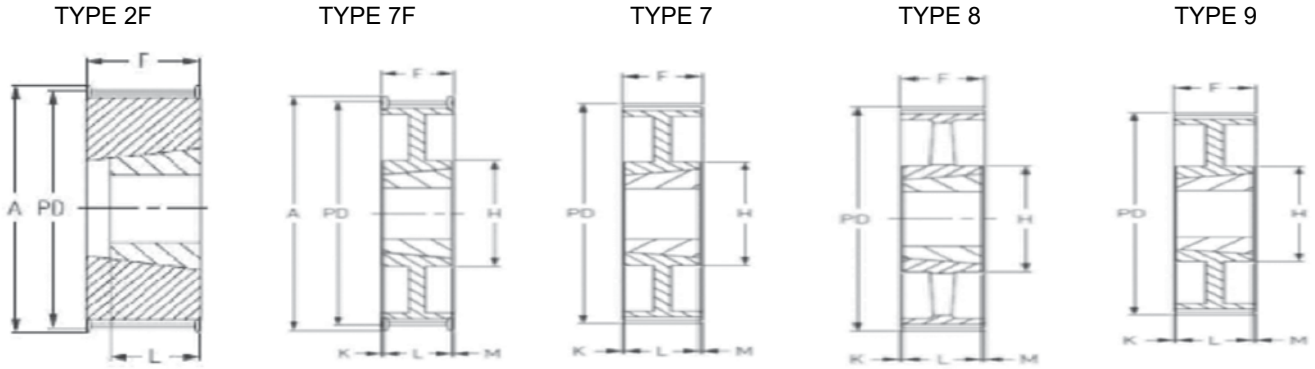

**L 3/8" (9,525mm)**  
**KONİK BURÇLU / With Taper Bush**

L075		Kayış Geniřlięi 19,1 mm For Belt Widths 19,1 mm									
Diř SAYISI Teeth No	ÇAP Diameter		TİP Type	BURÇ Bush	DELİK Bore		BOYUTLAR Dimension				
	P.D	A			Min.	Max.	H	F	K	L	M
	mm	mm			mm	mm	mm	mm	mm	mm	mm
18	54.57	60	2F	1108	10	28	-	25.4	-	25.4	-
19	57.61	63	2F	1108	10	28	-	25.4	-	25.4	-
20	60.64	66	2F	1108	10	28	-	25.4	-	25.4	-
21	63.67	69	2F	1108	10	28	-	25.4	-	25.4	-
22	66.7	72	2F	1108	10	28	-	25.4	-	25.4	-
23	69.73	78	2F	1108	10	28	-	25.4	-	25.4	-
24	72.77	78	2F	1108	10	28	-	25.4	-	25.4	-
25	75.8	85	2F	1108	10	28	-	25.4	-	25.4	-
26	78.83	85	2F	1108	10	28	-	25.4	-	25.4	-
27	81.86	91	2F	1108	10	28	-	25.4	-	25.4	-
28	84.89	91	2F	1108	10	28	-	25.4	-	25.4	-
30	90.96	97	2F	1108	10	28	-	25.4	-	25.4	-
32	97.02	103	2F	1108	10	28	-	25.4	-	25.4	-
36	109.15	115	2F	1610	13	42	-	25.4	-	25.4	-
40	121.28	127	2F	1610	13	42	-	25.4	-	25.4	-
42	127.34	139	2F	1610	13	42	-	25.4	-	25.4	-
44	133.4	139	2F	1610	13	42	-	25.4	-	25.4	-
48	145.53	152	7F	1610	13	42	92	25.4	-	25	-
60	191.91	-	7	1610	13	42	92	25.4	-	25	-
72	218.3	-	8	1610	13	42	92	25.4	-	25	-
84	254.68	-	9	2012	19	50	111	25.4	3.5	32	3.5
96	291.06	-	9	2012	19	50	111	25.4	3.5	32	3.5
120	363.83	-	9	2012	19	50	111	25.4	3.5	32	3.5

TYPE 2F

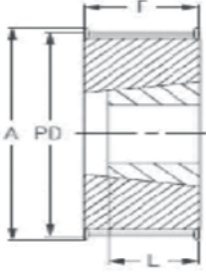

TYPE 7F

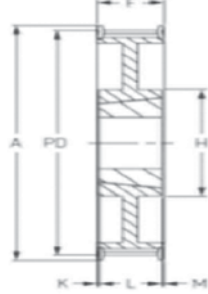

TYPE 7

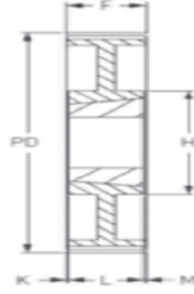

TYPE 8

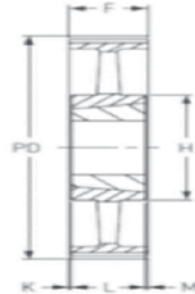

TYPE 9

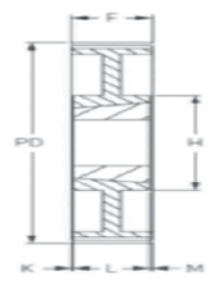

**L 3/8" (9,525mm)**

**KONİK BURÇLU / With Taper Bush**

L100	Kayış Geniřliđi 25,4 mm For Belt Widths 25,4 mm										
Diř SAYISI Teeth No	ÇAP Diameter		TİP Type	BURÇ Bush	DELİK Bore		BOYUTLAR Dimension				
	P.D	A			Min.	Max.	H	F	K	L	M
	mm	mm			mm	mm	mm	mm	mm	mm	mm
18	54.57	60	2F	1108	10	28	-	25.4	-	25.4	-
19	57.61	63	2F	1108	10	28	-	25.4	-	25.4	-
20	60.64	66	2F	1108	10	28	-	25.4	-	25.4	-
21	63.67	69	2F	1108	10	28	-	25.4	-	25.4	-
22	66.7	72	2F	1108	10	28	-	25.4	-	25.4	-
23	69.73	78	2F	1108	10	28	-	25.4	-	25.4	-
24	72.77	78	2F	1108	10	28	-	25.4	-	25.4	-
25	75.8	85	2F	1108	10	28	-	25.4	-	25.4	-
26	78.83	85	2F	1108	10	28	-	25.4	-	25.4	-
27	81.86	91	2F	1108	10	28	-	25.4	-	25.4	-
28	84.89	91	2F	1108	10	28	-	25.4	-	25.4	-
30	90.96	97	2F	1108	10	28	-	25.4	-	25.4	-
32	97.02	103	2F	1108	10	28	-	25.4	-	25.4	-
36	109.15	115	2F	1610	13	42	-	25.4	-	25.4	-
40	121.28	127	2F	1610	13	42	-	25.4	-	25.4	-
42	127.34	139	2F	1610	13	42	-	25.4	-	25.4	-
44	133.4	139	2F	1610	13	42	-	25.4	-	25.4	-
48	145.53	152	7F	1610	13	42	92	25.4	-	25	-
60	191.91	-	7	1610	13	42	92	25.4	-	25	-
72	218.3	-	8	1610	13	42	92	25.4	-	25	-
84	254.68	-	9	2012	19	50	111	25.4	3.5	32	3.5
96	291.06	-	9	2012	19	50	111	25.4	3.5	32	3.5
120	363.83	-	9	2012	19	50	111	25.4	3.5	32	3.5

TYPE 2F

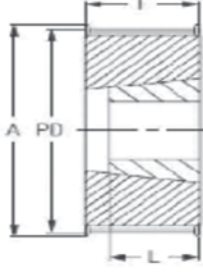

TYPE 14F

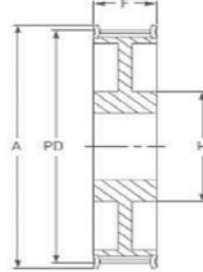

TYPE 9F

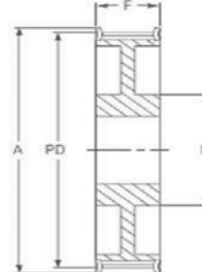

TYPE 9

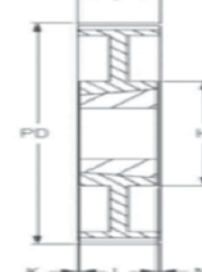

**H 1/2" (12,7mm)**

**KONİK BURÇLU / With Taper Bush**

H075	Kayış Geniřlięi 19,1 mm For Belt Widths 19,1 mm										
DİŐ SAYISI Teeth No	ÇAP Diameter		TİP Type	BURÇ Bush	DELİK Bore		BOYUTLAR Dimension				
	P.D	A			Min.	Max.	H	F	K	L	M
	mm	mm			mm	mm	mm	mm	mm	mm	mm
14	56.6	63	2F	1108	10	28	-	27	-	22	-
15	60.64	67	2F	1108	10	28	-	27	-	22	-
16	64.68	71	2F	1108	10	28	-	27	-	22	-
17	68.72	75	2F	1108	10	28	-	27	-	22	-
18	72.77	79	2F	1210	11	32	-	27	-	25	-
19	76.81	83	2F	1210	11	32	-	27	-	25	-
20	80.85	87	2F	1210	11	32	-	27	-	25	-
21	84.89	91	2F	1210	11	32	-	27	-	25	-
22	88.94	95	2F	1210	11	32	-	27	-	25	-
23	92.98	98	2F	1610	13	42	-	27	-	25	-
24	97.02	103	2F	1610	13	42	-	27	-	25	-
25	101.06	107	2F	1610	13	42	-	27	-	25	-
26	105.11	111	2F	1610	13	42	-	27	-	25	-
27	109.15	115	2F	1610	13	42	-	27	-	25	-
28	113.19	119	2F	1610	13	42	-	27	-	25	-
29	117.23	123	2F	1610	13	42	-	27	-	25	-
30	121.28	127	2F	1610	13	42	-	27	-	25	-
32	129.36	135	14F	1610	13	42	92	27	-	25	-
33	133.4	142	14F	1610	13	42	92	27	-	25	-
34	137.45	142	14F	1610	13	42	92	27	-	25	-
35	141.49	151	14F	1610	13	42	92	27	-	25	-
36	145.53	151	14F	1610	13	42	92	27	-	25	-
38	153.62	158	14F	1610	13	42	92	27	-	25	-
40	161.7	168	14F	1610	13	42	92	27	-	25	-
44	177.87	184	9F	2012	14	50	106	27	2.5	32	2.5
48	194.04	200	9F	2012	14	50	106	27	2.5	32	2.5
60	242.55	-	9	2012	14	50	106	27	2.5	32	2.5
72	291.06	-	9	2012	14	50	112	27	2.5	32	2.5
84	339.57	-	9	2012	14	50	112	27	2.5	32	2.5
96	388.08	-	9	2517	16	60	125	27	9	45	9
120	485.1	-	9	2517	16	60	125	27	9	45	9



TYPE 4F

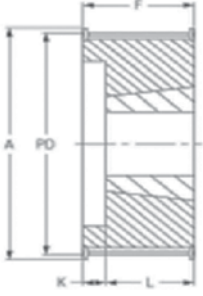

TYPE 13F

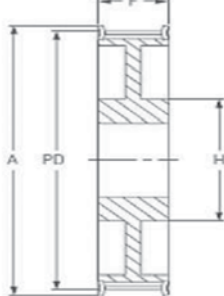

TYPE 14F

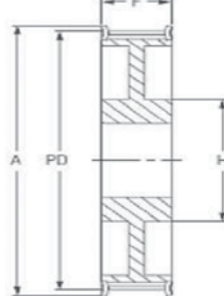

TYPE 8

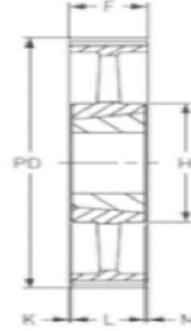

TYPE 9

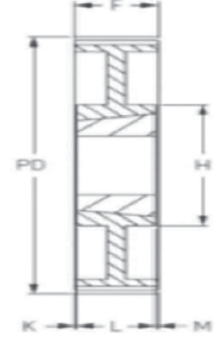

**H 1/2" (12,7mm)**

**KONİK BURÇLU / With Taper Bush**

H100	Kayış Geniřlięi 25,4 mm For Belt Widths 25,4 mm										
Diř SAYISI Teeth No	ÇAP Diameter		TİP Type	BURÇ Bush	DELİK Bore		BOYUTLAR Dimension				
	P.D	A			Min.	Max.	H	F	K	L	M
	mm	mm			mm	mm	mm	mm	mm	mm	mm
14	56.6	63	4F	1108	10	28	-	31	9	22	-
15	60.64	67	4F	1108	10	28	-	31	9	22	-
16	64.68	71	4F	1108	10	28	-	31	9	22	-
17	68.72	75	4F	1108	10	28	-	31	9	22	-
18	72.77	79	4F	1210	11	32	-	31	6	25	-
19	76.81	83	4F	1210	11	32	-	31	6	25	-
20	80.85	87	4F	1210	11	32	-	31	6	25	-
21	84.89	91	4F	1210	11	32	-	31	6	25	-
22	88.94	95	4F	1210	11	32	-	31	6	25	-
23	92.98	98	4F	1610	13	42	-	31	6	25	-
24	97.02	103	4F	1610	13	42	-	31	6	25	-
25	101.06	107	4F	1610	13	42	-	31	6	25	-
26	105.11	111	4F	1610	13	42	-	31	6	25	-
27	109.15	115	4F	1610	13	42	-	31	6	25	-
28	113.19	119	4F	1610	13	42	-	31	6	25	-
29	117.23	123	4F	1610	13	42	-	31	6	25	-
30	121.28	127	4F	1610	13	42	-	31	6	25	-
32	129.36	135	13F	1610	13	42	-	31	6	25	-
36	145.53	151	13F	1610	13	42	92	31	6	25	-
40	161.7	168	13F	1610	13	42	92	31	6	25	-
44	177.87	184	14F	2012	14	50	92	31	1	32	-
48	194.04	200	14F	2012	14	50	106	31	1	32	-
60	242.55	-	8	2012	14	50	106	31	1	32	1
72	291.06	-	8	2012	14	50	112	31	1	32	1
84	339.57	-	8	2012	14	50	112	31	1	32	1
96	388.08	-	9	2517	16	60	125	31	7	45	7

TYPE 4F

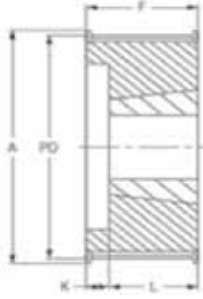

TYPE 13F

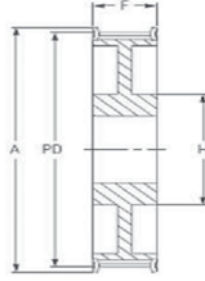

TYPE 14F

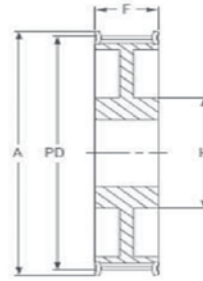

TYPE 8

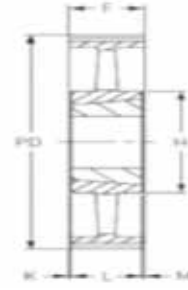

**H 1/2" (12,7mm)**

**KONİK BURÇLU / With Taper Bush**

H150	Kayış Geniřlięi 38,1 mm For Belt Widths 38,1 mm										
Diř SAYISI Teeth No	ÇAP Diameter		TİP Type	BURÇ Bush	DELİK Bore		BOYUTLAR Dimension				
	P.D	A			Min.	Max.	H	F	K	L	M
	mm	mm			mm	mm	mm	mm	mm	mm	mm
14	56.6	63	4F	1108	10	28	-	45	23	22	-
15	60.64	67	4F	1108	10	28	-	45	23	22	-
16	64.68	71	4F	1210	10	28	-	45	20	25	-
17	68.72	75	4F	1210	10	28	-	45	20	25	-
18	72.77	79	4F	1210	11	32	-	45	20	25	-
19	76.81	83	4F	1210	11	32	-	45	20	25	-
20	80.85	87	4F	1210	11	32	-	45	20	25	-
21	84.89	91	4F	1210	11	32	-	45	20	25	-
22	88.94	95	4F	1210	11	32	-	45	20	25	-
23	92.98	98	4F	1610	13	42	-	45	20	25	-
24	97.02	103	4F	1610	13	42	-	45	20	25	-
25	101.06	107	4F	1610	13	42	-	45	20	25	-
26	105.11	111	4F	1610	13	42	-	45	20	25	-
27	109.15	115	4F	1610	13	42	-	45	20	25	-
28	113.19	119	4F	1610	13	42	-	45	20	25	-
29	117.23	123	4F	1610	13	42	-	45	20	25	-
30	121.28	127	4F	1610	13	42	-	45	20	25	-
32	129.36	135	13F	1610	13	42	92	45	20	25	-
36	145.53	151	13F	1610	13	42	92	45	20	25	-
40	161.7	168	13F	1610	13	42	92	45	20	25	-
44	177.87	184	14F	2012	14	50	106	45	13	32	-
48	194.04	200	14F	2012	14	50	106	45	13	32	-
60	242.55	-	8	2012	14	50	106	45	6.5	32	6.5
72	291.06	-	8	2012	14	50	112	45	6.5	32	6.5
84	339.57	-	8	2012	14	50	112	45	6.5	32	6.5
96	388.08	-	8	2517	16	60	125	45	0.5	45	0.5
120	485.1	-	8	2517	16	60	125	45	-	45	-

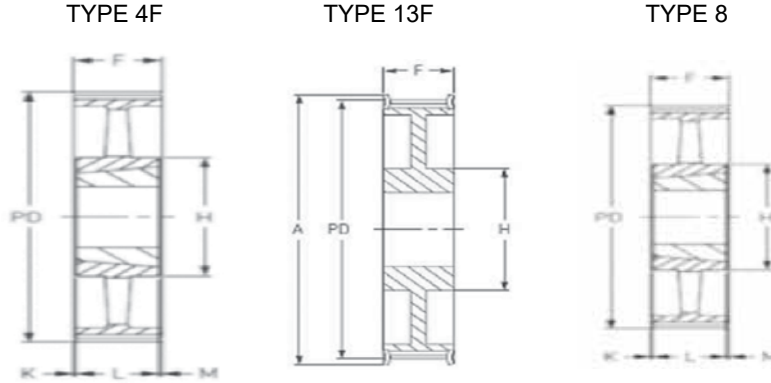

**H 1/2" (12,7mm)**  
**KONİK BURÇLU / With Taper Bush**

H200	Kayış Geniřlięi 50,8 mm For Belt Widths 50,8 mm										
Diř SAYISI Teeth No	ÇAP Diameter		TİP Type	BURÇ Bush	DELİK Bore		BOYUTLAR Dimension				
	P.D	A			Min.	Max.	H	F	K	L	M
	mm	mm			mm	mm	mm	mm	mm	mm	mm
16	64.68	71	4F	1108	10	28	-	58	36	22	-
17	68.72	75	4F	1210	10	28	-	58	33	25	-
18	72.77	79	4F	1210	11	32	-	58	33	25	-
19	76.81	83	4F	1610	11	32	-	58	33	25	-
20	80.85	87	4F	1610	11	32	-	58	33	25	-
21	84.89	91	4F	1610	11	32	-	58	33	25	-
22	88.94	95	4F	1610	11	32	-	58	33	25	-
23	92.98	98	4F	1610	13	42	-	58	33	25	-
24	97.02	103	4F	1610	13	42	-	58	33	25	-
25	101.06	107	4F	1610	13	42	-	58	33	25	-
26	105.11	111	4F	1610	13	42	-	58	33	25	-
27	109.15	115	4F	1610	13	42	-	58	33	25	-
28	113.19	119	4F	1610	13	42	-	58	33	25	-
29	117.23	123	4F	1610	13	42	-	58	33	25	-
30	121.28	127	4F	1610	13	42	-	58	33	25	-
32	129.36	135	4F	2012	13	42	-	58	26	32	-
36	145.53	151	13F	2012	13	42	106	58	26	32	-
40	161.7	168	13F	2012	13	42	106	58	26	32	-
44	177.87	184	13F	2012	14	50	106	58	26	32	-
48	194.04	200	13F	2517	14	50	125	58	13	45	-
60	242.55	-	8	2517	14	50	125	60	7.5	45	7.5
72	291.06	-	8	2517	14	50	125	60	7.5	45	7.5
84	339.57	-	8	2517	14	50	125	60	7.5	45	7.5
96	388.08	-	8	2517	16	60	125	60	7.5	45	7.5
120	485.1	-	8	2517	16	60	125	60	7.5	45	7.5

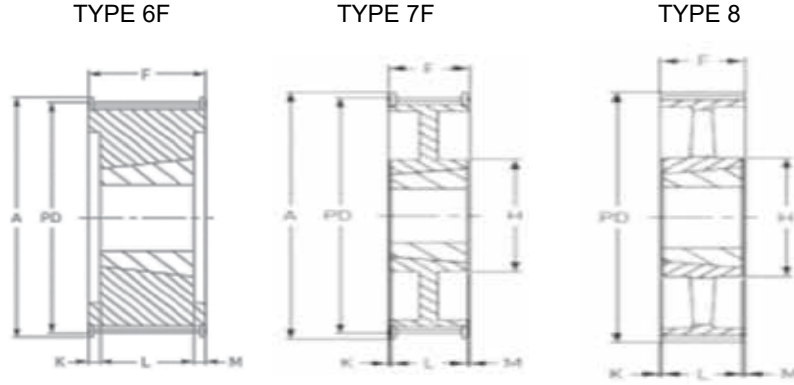

**H 1/2" (12,7mm)**

**KONİK BURÇLU / With Taper Bush**

H300	Kayış Geniřlięi 76,2 mm For Belt Widths 76,2 mm										
Diř SAYISI Teeth No	ÇAP Diameter		TİP Type	BURÇ Bush	DELİK Bore		BOYUTLAR Dimension				
	P.D	A			Min.	Max.	H	F	K	L	M
	mm	mm			mm	mm	mm	mm	mm	mm	mm
18	72.77	79	6F	1215	11	32	-	84	23	38	23
19	76.81	83	6F	1615	13	42	-	84	23	38	23
20	80.85	87	6F	1615	13	42	-	84	23	38	23
21	84.89	91	6F	1615	13	42	-	84	23	38	23
22	88.94	95	6F	1615	13	42	-	84	23	38	23
23	92.98	98	6F	1615	13	42	-	84	23	38	23
24	97.02	103	6F	1615	13	42	-	84	23	38	23
25	101.06	107	6F	1615	13	42	-	84	23	38	23
26	105.11	111	6F	1615	13	42	-	84	23	38	23
27	109.15	115	6F	2012	14	50	-	84	26	32	26
28	113.19	119	6F	2012	14	50	-	84	26	32	26
29	117.23	123	6F	2012	14	50	-	84	26	32	26
30	121.28	127	6F	2517	14	50	-	84	19.5	45	19.5
32	129.36	135	6F	2517	16	60	-	84	19.5	45	19.5
36	145.53	151	6F	2517	16	60	-	84	19.5	45	19.5
40	161.7	168	6F	2517	16	60	-	84	19.5	45	19.5
44	177.87	184	7F	2517	16	60	120	86	20.5	45	20.5
48	194.04	200	7F	2517	16	60	120	86	20.5	45	20.5
60	242.55	-	8	2517	16	60	120	86	20.5	45	20.5
72	291.06	-	8	2517	16	60	120	86	20.5	45	20.5
84	339.57	-	8	2517	16	60	120	86	20.5	45	20.5
96	388.08	-	8	3030	32	75	170	86	5	76	5
120	485.1	-	8	3030	32	75	170	86	5	76	5

**XH 7/8" (22,225mm)**

**KONİK BURÇLU / With Taper Bush**

XH200	Kayış Geniřlięi 50,8 mm For Belt Widths 50,8 mm										
	ÇAP Diameter		TİP Type	BURÇ Bush	DELİK Bore		BOYUTLAR Dimension				
	P.D	A			Min.	Max.	H	F	K	L	M
Diř SAYISI Teeth No	mm	mm			mm	mm	mm	mm	mm	mm	mm
18	127.34	141	6F	2012	14	50	-	65.1	-	32	-
19	134.41	156	6F	2012	14	50	-	65.1	-	32	-
20	141.49	155	6F	2012	14	50	-	65.1	-	32	-
21	148.56	169	6F	2517	16	60	-	65.1	-	45	-
22	155.64	169	6F	2517	16	60	-	65.1	-	45	-
24	169.79	183	6F	2517	16	60	-	65.1	-	45	-
25	176.86	198	6F	2517	16	60	-	65.1	-	45	-
26	183.93	198	6F	2517	16	60	-	65.1	-	45	-
27	191.01	212	7F	2517	16	60	120	65.1	10	45	10
28	198.09	212	7F	2517	16	60	120	65.1	10	45	10
30	212.23	226	7F	2517	16	60	120	65.1	10	45	10
32	226.38	240	7F	2517	16	60	120	65.1	10	45	10
36	254.64	267	8	2517	16	60	120	65.1	10	45	10
40	282.98	-	8	3020	25	75	170	65.1	7	51	7
48	339.57	-	8	3020	25	75	170	65.1	7	51	7
60	424.47	-	8	3020	25	75	170	65.1	7	51	7

TYPE 6F

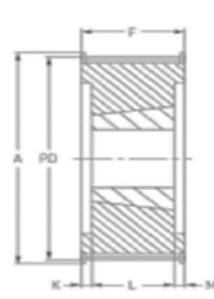

TYPE 7F

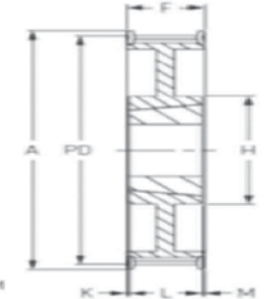

TYPE 8

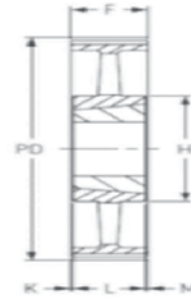

**XH 7/8" (22,225mm)**

**KONİK BURÇLU / With Taper Bush**

XH300	Kayış Geniřlięi 76,2 mm For Belt Widths 76,2 mm										
	ÇAP Diameter		TİP Type	BURÇ Bush	DELİK Bore		BOYUTLAR Dimension				
	P.D	A			Min.	Max.	H	F	K	L	M
Diř SAYISI Teeth No	mm	mm			mm	mm	mm	mm	mm	mm	mm
18	127.34	141	6F	2012	14	50	-	92.1	-	32	-
19	134.41	156	6F	2517	16	60	-	92.1	-	45	-
20	141.49	155	6F	2517	16	60	-	92.1	-	45	-
21	148.56	169	6F	2517	16	60	-	92.1	-	45	-
22	155.64	169	6F	2517	16	60	-	92.1	-	45	-
24	169.79	183	6F	2517	16	60	-	92.1	-	45	-
25	176.86	198	6F	2517	16	60	-	92.1	-	45	-
26	183.93	198	6F	2517	16	60	-	92.1	-	45	-
27	191.01	212	6F	2517	16	60	-	92.1	-	45	-
28	198.09	212	7F	2517	16	60	120	92.1	23.5	45	23.5
30	212.23	226	7F	2517	16	60	120	92.1	23.5	45	23.5
32	226.38	240	7F	3020	25	75	170	92.1	20.5	51	20.5
36	254.64	267	7F	3020	25	75	170	92.1	20.5	51	20.5
40	282.98	-	8	3020	25	75	170	92.1	20.5	51	20.5
48	339.57	-	8	3020	25	75	170	92.1	20.5	51	20.5
60	424.47	-	8	3020	25	75	170	92.1	20.5	51	20.5

TYPE 6F

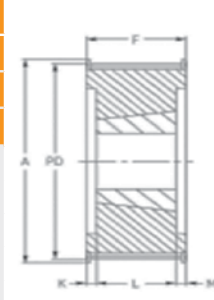

TYPE 7F

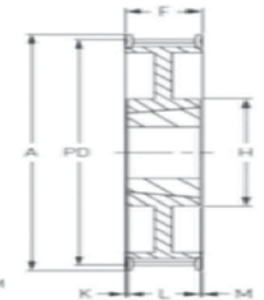

TYPE 8

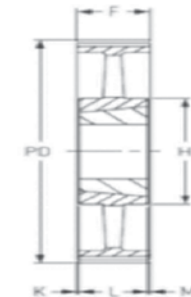

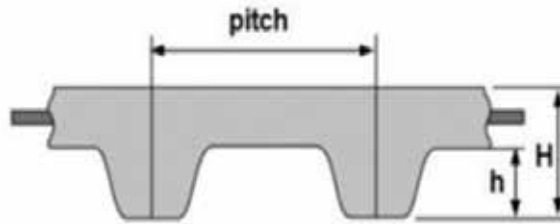
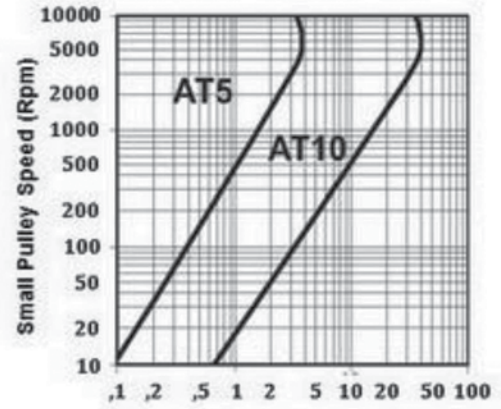
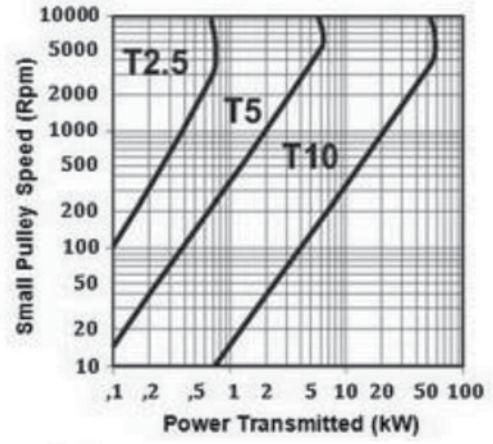
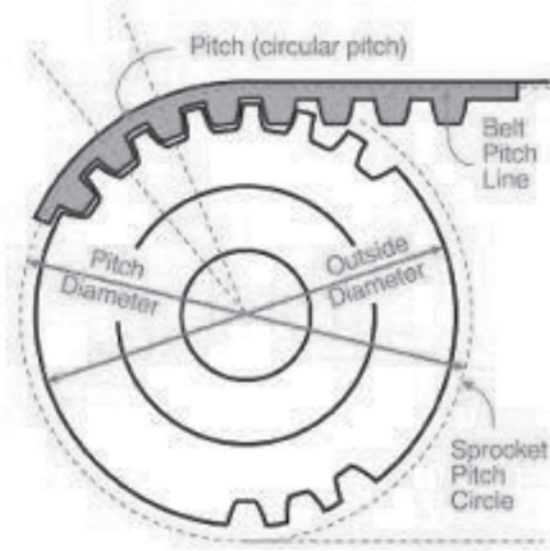

TİP Type	ADIM(P) Pitch mm	h	H	a°
T 2,5	2.5	0.7	1.3	40
T 5	5	1.2	2.2	40
T 10	10	2.5	4.5	40
AT 5	5	1.2	2.5	50
AT 10	10	2.7	4.5	50